

Review Navigation Options in Google Drive

Work with files stored in Drive.

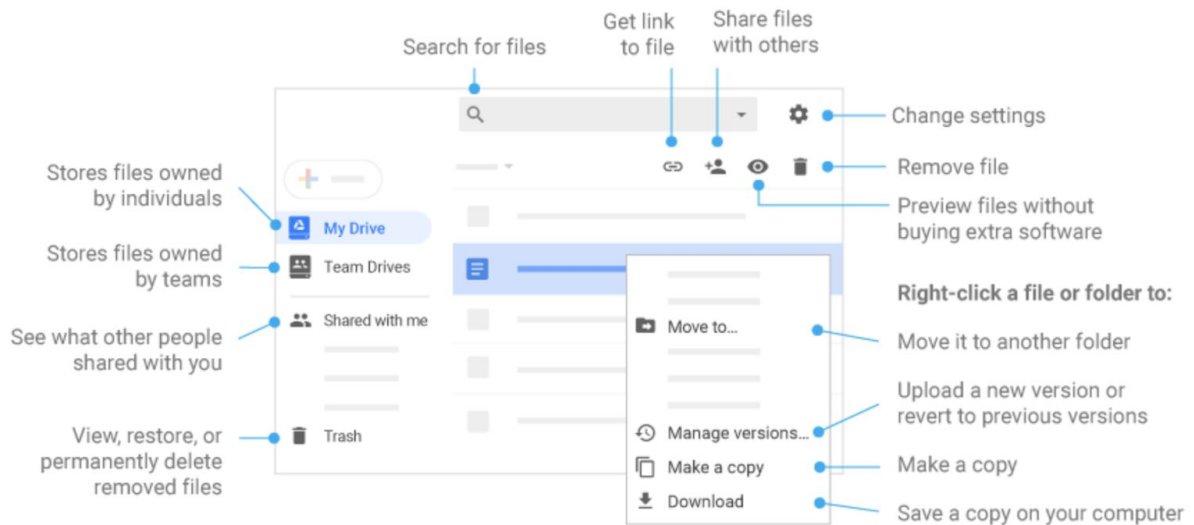

My Drive:	Stores files owned by the user
Team Drives:	Files owned by teams in your organization. Students do not have Team Drives at VIS.
Shared With Me:	This is where you will find files that other people have shared with you.
Recent:	Will display files that you have recently accessed, viewed or edited.
Trash:	Files that have been deleted are moved in this temporary area prior to permanent deletion.